

1490009004

Wall-Mount Bracket for ITSV-2



Description

Used for wall mounting of the ITSV-2 Video Station.

Technical Dimensions

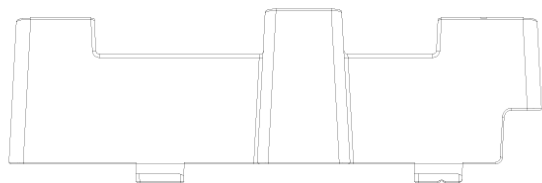
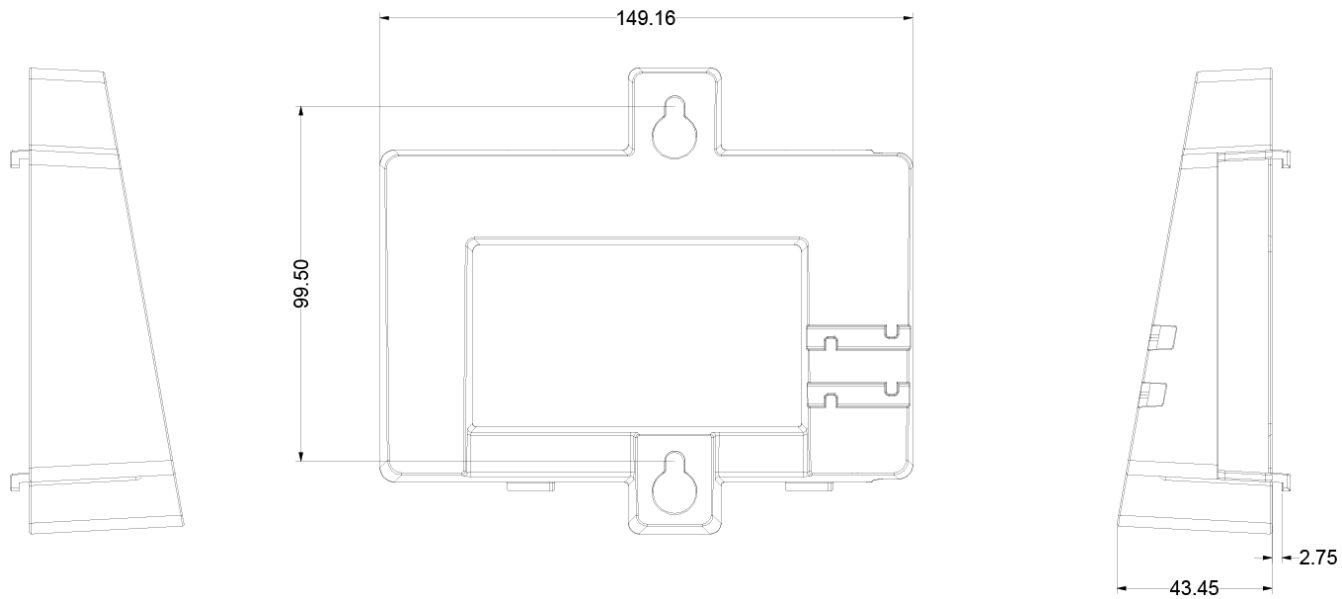
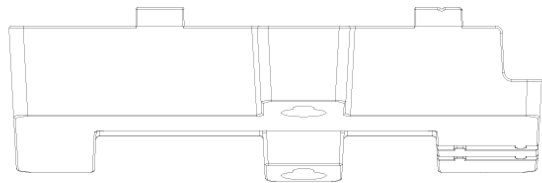

Specifications

GENERAL

Dimensions (WxHxD)	149.16 x 99.5 x 43.45 mm
--------------------	--------------------------

Used With



ITSV-2

Powerful Desktop Video Phone with 5" capacitive touch screen and support for 720p HD video.