



4000019391

## ITCS-C6

### Call and Reset unit

- ✓ Water resistant (IP56)
- ✓ Illuminated Call button (green)
- ✓ Illuminated Reset button (red)

## Description

ITCS-C6 is water-resistant (IP 56) unit for calling and call reset. Call is done with illuminated green "CALL" push button. When call is done, red bulb situated in "RESET" push button is lighted up. Call reset can be done by that push button. After call is reset, red light goes off. Green bulb in "CALL" push button lights all the time (when system is on), to ensure visibility in dark spaces

## Technical Dimensions

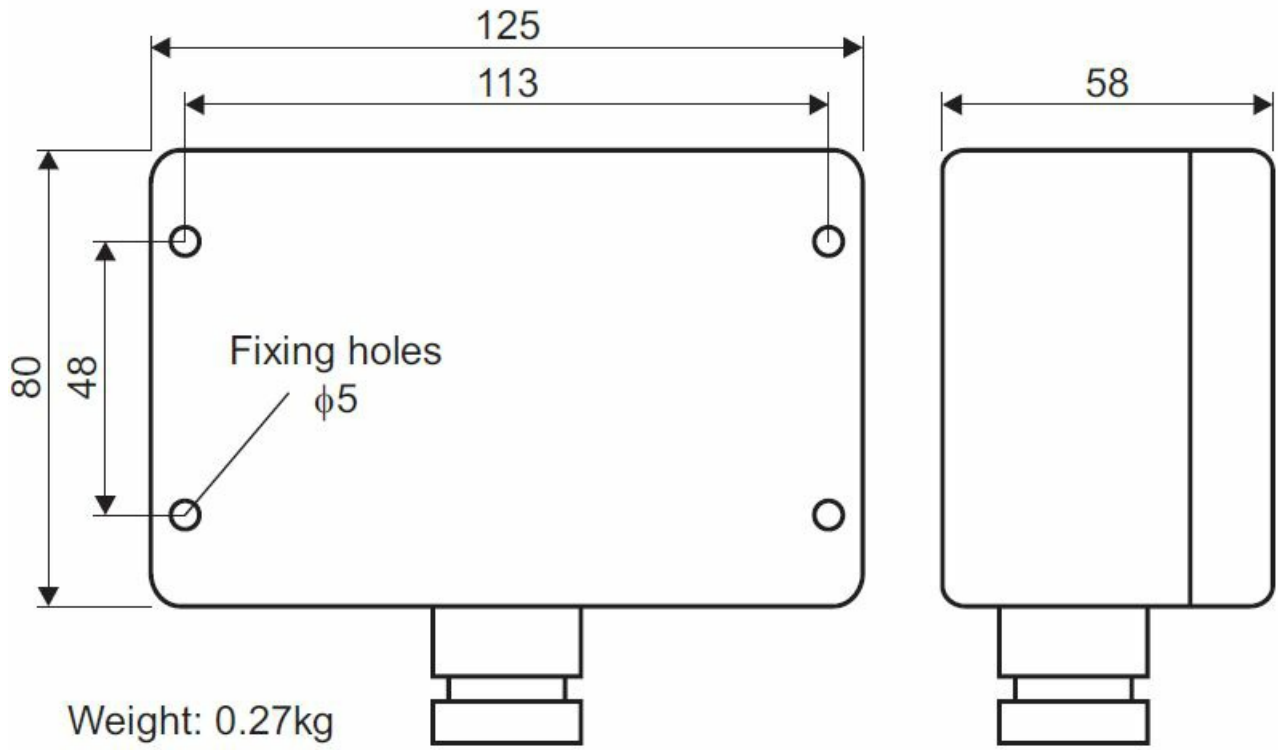

# Specifications

## TECHNICAL

Dimensions (WxHxD)	80 x 125 x 58 mm (HxWxD)
Weight	0.27 kg
Cable entry	1 pc. Gland - PG13.5
Power consumption	24VDC / 0.026A

## CONNECTION:

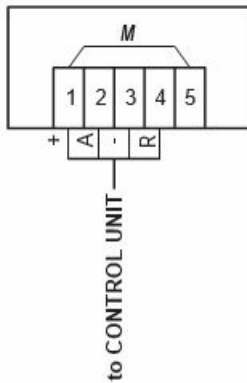

## NOTE:

If more calling units type ITCS-C4, C5 or C6 is used for same calling place/line, terminals 1,2,3 are connected in parallel and terminals 4,5 in series. Put link *M* on last unit in chain.

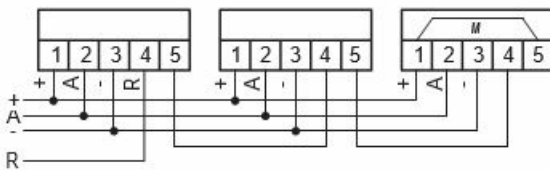

## Used With



ITCS-1A-24VDC

Single Call Control Unit, 24 VDC



ITCS-1A-230VAC

Single Call Control Unit, 230 VAC



ITCS-2A-24VDC

Double Call Control Unit, 24 VDC



ITCS-2A-230VAC

Double Call Control Unit, 230 VAC