

2340110035

SPA-M6-V2

PA Panel Single with 6 zones, All Call, Dimmer, Flush, Green Backlight



- ✓ PA panel for single system
- ✓ Built-in pre-amplifier with preset signal level and tone controls
- ✓ 6 zone selection buttons
- ✓ ALL, TALK and dimmer buttons.
- ✓ Replaceable text label to each zone button
- ✓ Zone buttons have activation confirmation light
- ✓ Flush mounting, back box for wall mounting is available
- ✓ Local mute contact for external loudspeaker
- ✓ Buttons backlight with green illumination



Onboard communication

Description

Zenitel SPA-M6 V2 Panel gives messages in one to six zones in a SPA-V2 public address and general alarm single system. Installation in consoles or on-wall indoor.

Function Local mute is used for instances where feedback is caused by close proximity between a PA panel and a loudspeaker. This function must be in combination with relay box.

Note: Microphone must be ordered separately.

Technical Dimensions

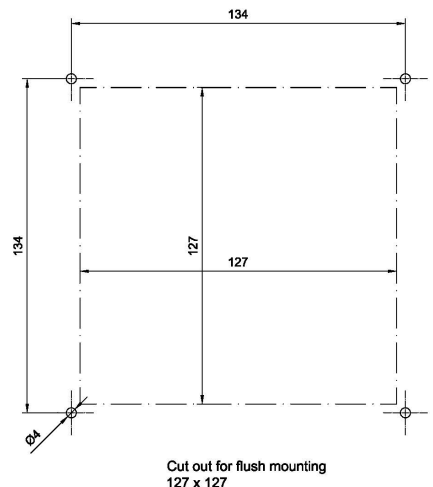
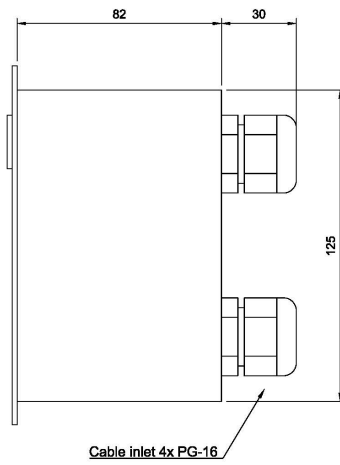
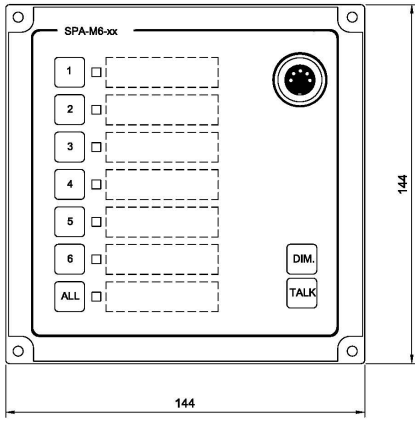

Cable inlet 4x PG-16

Cut out for flush mounting
127 x 127

Related Item:
 SPA-M6BOKS Wall mounting box for SPA-M1/M6 panels Item.no. 3005010155
 MB-30G Gooseneck Microphone Item.no.3005020033
 ETC-1-TB Hand Microphone Item.no.3005020029

Specifications

GENERAL

Size (WxHxD)	144 x 144 x 82
Weight w/microphone	0.5 kg
Material	Black anodized aluminium
Mounting	Flush, wall with use of back box
Output signal	0.775Vrms / 0dB
Connections	Plugable screw terminals for 2.5 mm ² cable
Cable glands	4 x PG-16
Cable size	6 x 2 x 0.75 mm ²
Local mute relay, output	24V DC @ maximum 50mA
IP-rating	IP-44
Operating temperature	-15°C to +55°C

Accessories

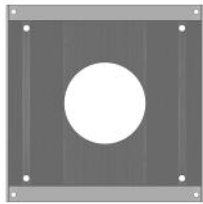

SPA-M6BOKS

Wall-mount box for SPA-M1/M6 and VM15/50-RD panels



MB-30G

Gooseneck Microphone



PAM2H

Handheld Microphone for SPA-V2 indoor panels.