

1015818

PSU-FLT

AC Filter, DIN, 1-Phase, max. 250VAC/10A



- ✓ 1-Phase Power Supply Filter
- ✓ DIN rail mounting
- ✓ Suppresses interference generated on the mains side of power supplies
- ✓ Efficiently filters out line bound interference emissions
- ✓ Increases the interference immunity of connected loads

Technical Dimensions

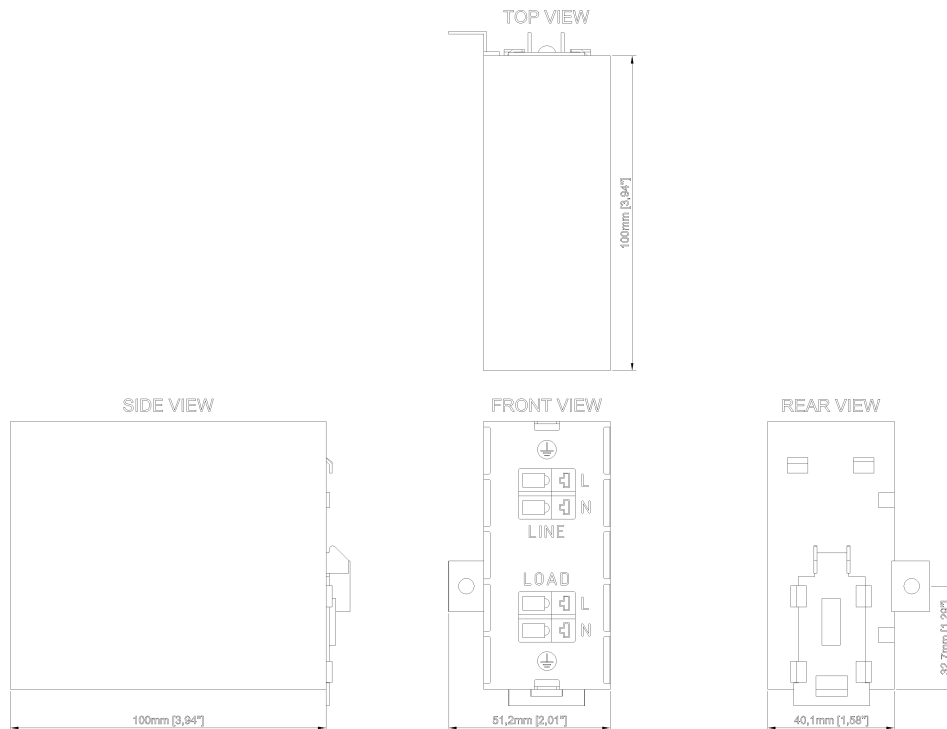

Specifications

SPECIFICATION

Filter type	anti-interference
Input voltage range	0 - 250 VAC
Nominal mains frequency range	50 - 60 Hz
Input current	≤ 10 A
Power loss	≤ 4 W
Connection technology	CAGE CLAMP
Operating temperature	-25 to 70°C
Mounting	DIN Rail
Body dimensions (WxHxD)	50 x 85 x 100 mm
Weight	0.34 kg
Parallel operation	Yes
Series operation	No
Protection type	IP20